

STANDARD F

hs-CRP FIA SD BIOSENSOR

STANDARD F hs-CRP FIA is an immunoassay for the quantitative measurement of C-reactive protein level in human serum, plasma and whole blood. This test is performed to help predict a healthy person's risk of cardiovascular disease as part of cardiovascular disease part of a cardiovascular risk profile.

- Automatic strip recognition by reading the information stored in 2D barcode
- Reagents can be stored at room temperature : 2-30°C / 36-86°F
- Serum, Plasma and Whole blood samples available



Specification

| | |
|--------------------|---|
| Intended use | Quantitative measurement of hs-CRP level to predict a healthy person's CVD risk |
| Specimen Type | Whole blood, Serum, Plasma |
| Specimen Volume | 5 µl |
| Measurement Range | 0.1 – 15 mg/L |
| Reference Range | < 1.0 (Normal) 1.0 – 3.0 (Average risk) > 3.0 (High risk) |
| Specimen Volume | 5 µl |
| Testing Time | 3 mins. |
| Storage Conditions | 2-30°C / 36-86°F |

TEST PROCEDURE

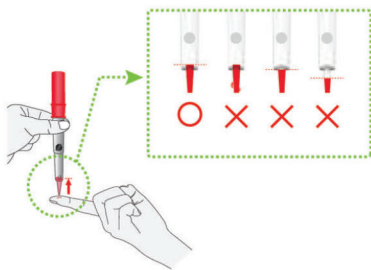

Collect 5 µl of sample. Finger tip blood can be used.

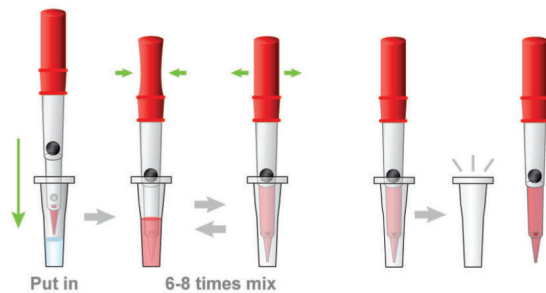

Put in
6-8 times mix
Mix collected sample with an extraction buffer until a latex tablet dissolves perfectly.

Collect all the mixture with a Spoit™(Red).



Apply the sample mixture into the sample well of the test device.
Read After 3mins

METHOD COMPARISON

Reference Method vs STANDARD F CK-MB FIA

| | |
|-------------------------------|---|
| Correlation with ECLIA Method | $y=0.9994x-0.01$; $R=0.9989$; $n=120$ |
| CV% | QCL=7.6% / QCM=9.7% / QCH=9.8% |
| Differ (%) | Within 15% |

ORDERING INFORMATION

| Category | Product | Pack Size |
|----------------|---------------------------|---------------------|
| Cardiovascular | STANDARD F hs-CRP FIA | 20 Test |
| | STANDARD F hs-CRP Control | Lv1 x 10 / Lv2 x 10 |